



Pneumatic Pilot Valve

Stainless Steel, with Female Thread



measuring
•
monitoring
•
analysing



- pmax. PN 16
- tmax. +180 °C
- Connections:
screw thread G 1/2 bis G 2
- Short opening and closing times
- Pilot pressure: 6 bar
- Seals: PTFE
- Function: "normally closed"



KOBOLD companies worldwide:

ARGENTINA, AUSTRIA, BELGIUM, CANADA, CHILE, CHINA, CZECHIA,
FRANCE, GERMANY, GREAT BRITAIN, INDIA, INDONESIA, ITALY,
MALAYSIA, MEXICO, NETHERLANDS, POLAND, SINGAPORE, SLOVAKIA,
SPAIN, SWITZERLAND, THAILAND, USA, VENEZUELA, VIETNAM

KOBOLD Messring GmbH
Nordring 22-24
D-65719 Hofheim/Ts.
☎ +49(0)6192 299-0
Fax +49(0)6192 23398
E-Mail: info.de@kobold.com
Internet: www.kobold.com

Model:
KUP-PV

Design

Seat valve with conical seal

Control function

In rest position, the valve is closed against flow; upon application of control pressure, it opens.

- Control medium: air
- Pilot pressure: 6 bar
- Control connection: G 1/4
- Mounting position: any,
note specified direction of flow

Technical Details

- Connections: female thread G 1/2 to G 2
- Temperature range: -30°C to +180°C
- Nominal pressure: PN 6 to PN 16 (see table)

Materials

- Body: stainless steel
- Control cylinder: stainless steel
- Internal parts: stainless steel
- Seal: PTFE

KUP-PV

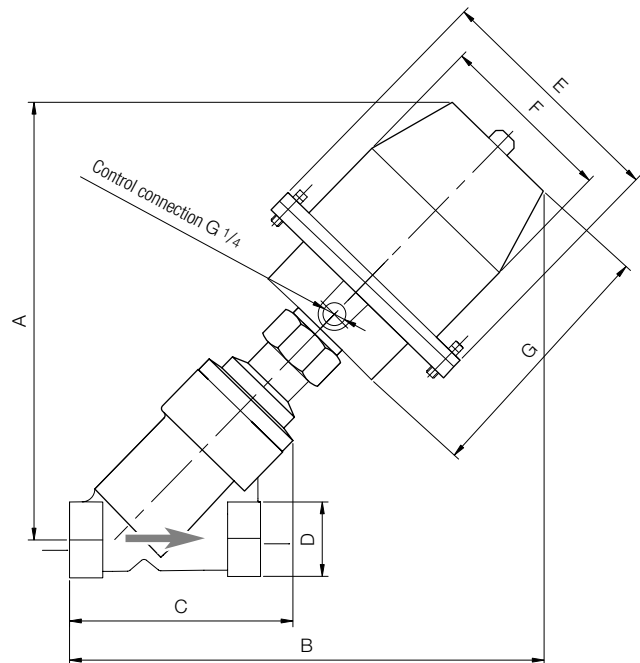

Dimensions and Order Details (example: KUP-PVR 15)

Screw thread [G]	Order no.	A [mm]	B [mm]	C [mm]	D [mm]	E [mm]	F [mm]	G [mm]	k _v -value [m ³ /h]	Nominal pressure [bar]	Weight [kg]
1/2	KUP-PVR 15	170	185	71	30	96	70	101	3.8	16	2.15
3/4	KUP-PVR 20	170	190	79	37	96	70	101	8.0	10	2.25
1	KUP-PVR 25	175	195	97	42	96	70	101	15.0	6	2.60
1 1/4	KUP-PVR 32	225	250	110	52	112	86	140	23.0	12	4.20
1 1/2	KUP-PVR 40	225	250	120	60	112	86	140	30.0	8	5.00
2	KUP-PVR 50	225	250	140	72	112	86	140	46.0	6	5.55